

## Components & Parts

---

### Experience matters

1991 Founded as RETEK Goslar Recycling GmbH as spin-off from German ore mining company **PREUSSAG** AG – Germany, first solutions for recycling of WEEE development of delamination systems for compound materials to recover and separate metals

2007 Take over by E-Waste Solutions Inc. Canada, driven by Alfred Hamsch former owner and president of **GEEP** – Canada (Global Electric and Electronic Processing Inc., Barrie, Ontario, Canada)

2008 Renaming to RETEK Engineering GmbH, adaptation of technology to compound materials like e.g. mixed metal scrap.

2013 Renaming to UMS – Urban Mining Solutions GmbH

2014 Founding of Mesatex as production center on loan basis and as UMS development and testing center



Since machines were not available on the market or did not meet the requirements, UMS developed and continues to develop its own components and solutions to increase the efficiency of material processing and separation.

UMS extended this even to operational parts based on its own processing and operational know-how experienced during running Mesatex production center.

### Linear Screening Machines (LSM)



## Linear Screening Machines (LSM)

The LSM screens solid mixtures according to their particle size.

UMS has developed own Linear Screening Machines, since no product was available on the market fulfilling our requirements at the time.

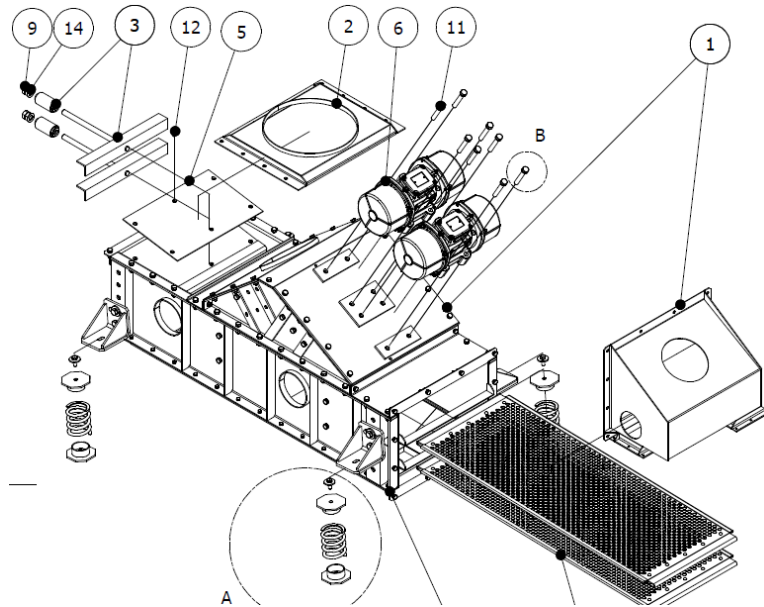

The LSM can be equipped with three stacked screen inserts resulting in four screen cuts. A wide range of different screen inserts are available.

The LSM is driven by two counter-acting unbalance motors vibrating the unit with the firmly tensioned screen inserts. The linear vibration exerts force impulses on the material, which convey it in throwing movements into the direction of the screen discharge. Depending on the particle size, the screening material passes through the different screen inserts, and is fractioned into the corresponding particle size divisions.

UMS optimizes and adds the LSM to

existing systems also not limited to selection, positioning and integration therein.

In addition to the LSM, UMS developed further particularly very special screening solutions for materials difficult to screen with standard machines e. g. E-scrap, material containing wires.

### Technical data

Model	Width (mm)	Length (mm)	Screen inserts	Drive (kW) at 400 V	Weight (kg) approx.
LSM 500-1300	500	1,300	1 or 2	2 x 0.35	450
LSM 500-1900	500	1,900	1, 2 or 3	2 x 0.68	700
LSM 1000-1900	1,000	1,900	1, 2 or 3	2 x 0.95	1,000

other dimensions are available on request

We offer the LSM as single machines without or with the supporting steel structure executed as standard or tailor-made to your requirements. Extension of or integration into your operating system is also possible.

### How to Proceed

If you request an offer or want to purchase a Linear Screening Machines (LSM) directly, please contact our department for component and parts as follows

phone: +49 (0) 21 91 / 422 22 64

email: [parts@urbamine.de](mailto:parts@urbamine.de)